



# The Meadow Sweet Circular



NEWSLETTER FOR THE COTTAGES AT RIVENDELL

RIVENDELL UNIT #1 JULY, 2005 EDITION

**Margery Arendt, Editor**

**(941) 918-0953**

**MargArendt@aol.com**

**Fax# (941) 918-4314**

TRACY ARENDT - TECHNICAL COORDINATOR

**For Newsletter and Community info when you're out of town, visit: [www.thecottagesofrivendell.com](http://www.thecottagesofrivendell.com)**



## What's in the Works

1. A new cleaning service has been hired to clean the clubhouse bathrooms twice a week, the clubhouse once a month, and the windows every six months.
2. Three leaks in the pool were repaired.
3. Southwest Pools has been hired to clean the pool twice a week and make repairs as needed. This is the same company that cleans the master association pool.
4. A hinge on the Ladies Room door (at the clubhouse) was repaired.
5. In the last couple of weeks, Valley Crest has trimmed the trees and hedges on Meadow Sweet Circle.

## Activities Fund Report



Below you will find the current monthly Activities Fund report for June, 2005:

<b>BEGINNING BALANCE:</b>			<b>\$811.97</b>
Jun 9	Wine Tasting Party	-\$16.82	\$800.15
Jun 11	Kitchen Supplies	-\$21.38	\$778.77
	Tea Kettle & Carafe		
Jun 21	Coffee	\$4.69	783.46
<b>ENDING BALANCE:</b>			<b>\$783.46</b>

## Community Association Bylaws Reminder

The following amendment is a part of the Declaration of Protective Covenants, Conditions and Restrictions for Rivendell:

New Section 4.09 entitled "Hurricane Shutters" as set forth herein shall be added to Article IV of the Community Declaration: (Text underlined is Added)

**4.06 Hurricane Shutters.** Any hurricane or other protective devices visible from the outside of a home or unit shall be of a type as approved by the Architectural Review Board, and in accordance with the guidelines as promulgated by the Architectural Review Board. No such devices shall be installed without the prior written approval of the Architectural Review Board. Except as otherwise provided in this Section, an owner's accordion, roll-up, panel, or other style storm shutters must be left in an open position at all times. Whether they consist of accordion, roll-up, panel, or any other style shutter, the owner may only install, operate, or have in a closed or down position, storm shutters if and when the National Weather Service has issued a hurricane watch for the County or Municipality where the owner's dwelling is located. All storm shutters must be returned to the open or up position within seventy-two (72) hours after such hurricane watch expires or is otherwise no longer in effect. In no event shall an owner rely upon any other party to operate the owner's storm shutters, to either remove, close or open such shutters, and each owner is individually responsible for the full operation of their storm shutters. If any owner fails to comply with the terms of this Section, such owner shall be subject to the imposition of fines as detailed in this Declaration.

**Applications for ARDR approval for both HOA's are attached. Both must be submitted to the Unit1 Board before they are submitted to the Master Assoc.**

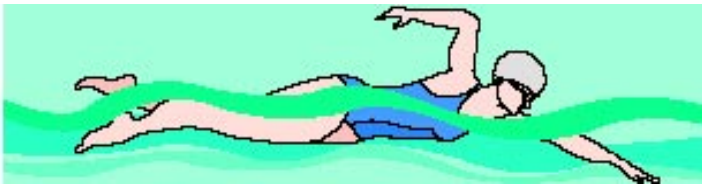

## POOL, PUPS & PARKING

The Board of Directors would like to remind everyone that the pool is meant to be enjoyed by all, and that means observing the rules and a little common courtesy. Remember:

- CHILDREN ARE NOT ALLOWED IN THE POOL OR POOL AREA WITHOUT ADULT SUPERVISION.
- POOL AREA FURNITURE SHOULD BE RETURNED TO IT'S ORIGINAL LOCATION BEFORE YOU LEAVE THE POOL.
- KEEP THE POOL AREA CLEAN, BOTH FOR APPEARANCE AND SAFETY REASONS. (THIS INCLUDES THE WASHROOMS.) POOL DECK CLEANLINESS IS **NOT** THE RESPONSIBILITY OF THE CLEANING CREW, BUT OF THE OWNER & GUESTS WHO MAKE USE OF IT.



We all love our pets, but their care and clean-up is the responsibility of their owners. Remember:

- LEASHES ARE **NOT** OPTIONAL. WHEN YOUR DOG IS NOT CONFINED ON YOUR PROPERTY, HE/SHE SHOULD BE LEASHED AND UNDER YOUR CONTROL AT ALL TIMES.
- DOG WASTE MUST BE PICKED-UP BY THE OWNER IMMEDIATELY AFTER IT IS DEPOSITED.
- DON'T ALLOW YOUR DOG TO BARK ENDLESSLY. THIS DISTURBS YOUR NEIGHBORS.

Over-night parking is not allowed without a permit.

Any board member can provide you and your over-night guests with a permit.



## Cottage Comments:

LETTERS TO  
THE EDITOR



Dear Neighbor,

I was interested to learn at the recent board meeting (6/14/05) that some ladies in the neighborhood would like to install some acoustic improvements and window treatments in our clubhouse. This is a worthwhile idea that must be put to a 2/3 vote of our association to pass, as our CCR'S state. I think it is great that these ladies care so much about our clubhouse (common property), and know they will go through the necessary process to accomplish this loft goal. Have a great Summer!

*Rosemary Haley, #565 MSC*

Many compliments have  
been received since the trimming  
around the Circle was completed.  
Thanks, Valley Crest,  
For a job well done!



**Air Conditioning  
and Plumbing  
Services**

Serving  
Osprey, Venice  
Sarasota

**Bohalls**  
**total comfort**  
HEATING AIR CONDITIONING  
Since 1966

FL. STATE CERTIFIED  
# CAC058768  
# CFC1425776



- Central Air Conditioning
- Special Filtration
- Mold Control
- Duct System Replacement

RESIDENTIAL & COMMERCIAL  
**1-888-264-2557**

**CARL E. BOHALL**

Prompt Service • Free Estimates

- Water Heaters
- Faucet & Fixture Replacement



## UPCOMING ACTIVITIES

HERE'S WHAT'S PLANNED FOR JULY:

**Sunday, July 3rd**  
**Summer Picnic at 5pm**

NO EVENTS ARE PLANNED FOR AUGUST.

COMING UP IN SEPTEMBER:

**Friday, September 23rd -**  
**Happy Hour at the Clubhouse**  
Hostesses: Kathy Perlman & Margery Arendt

## A Fond Farewell

At the June 19th Coffee, we said goodbye to two good neighbors, Lynn & Mel Jacobson. They have moved to The Fountains, and will be sorely missed. Lynn served on the original transition team which handled the transfer of authority from the builder to the Rivendell Unit One Homeowners Association. We wish them health and happiness and hope they stay in touch.



## Meadow Sweet Cuisine...

Recipes Contributed by your neighbors.



### Grapefruit-Mint Sorbet

Submitted by Margery Arendt

1/2 cup sugar  
1/2 cup water  
1/2 cup fresh mint leaves and stems  
1/2 cup fresh grapefruit juice (pink or green)  
Fresh mint sprigs for garnish

In a saucepan, combine sugar, water, mint leaves and stems; bring to a boil, lower heat and simmer for 5 minutes; remove from heat, cover and let cool.

Pour grapefruit juice and cooled mint mixture into a blender or food processor and blend well. Strain and transfer mixture to a shallow pan, cover and freeze until firm.

Transfer frozen mixture to a blender or food processor again and blend well. Freeze again in the shallow pan. When ready to serve, use a melon bailer and place 3 scoops in a stemmed glass, garnish with a sprig of fresh mint and serve. Makes 6-8 servings.

## Directory Corrections

Please note the correct spelling of Linda & Peter O'NEILL, 547 MSC.

The new resident at 578 is Jack TERRY. His phone number is 918-0108.

New residents at 581 MSC are Robert & Lauretta Stellato.

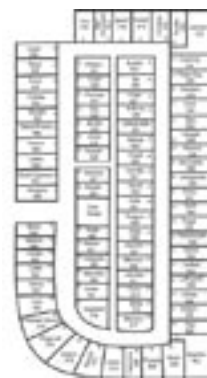

**RICHARD D. CLANCY, DC**

*Chiropractic, Acupuncture & Massage*

**8800 South Tamiami Trail, Suite A • Sarasota, Florida**

Diagnoses and treatment of neck pain and/or headaches,  
low back and/or leg pain, disc injuries, spinal stenosis and  
**automobile accident injuries.**

Most insurance accepted, including Medicare and Medicaid.



**SERVING SARASOTA SINCE 1981 • (941) 918-9195**

# JULY, 2005

## Calendar of Events

SUNDAY	MONDAY	TUESDAY	WEDNESDAY	THURSDAY	FRIDAY	SATURDAY
					1	2
3 Summer Picnic @ clubhouse 5 PM	4 	5	6	7	8	9
10	11	12	13	14	15	16
17	18	19	20	21	22	23
24	25	26	27	28	29	30
31						



## Right Side - Left Side

Submitted by Terry Sweeney



Ever wondered why the British drive on the left and Americans drive on the right? Apparently, hundreds of years ago, when there was no rule of the road, the Pope, was asked to give a ruling for the sake of safety and convenience.

He decided that all traffic should keep to the left, as this was the obvious side of the road for horsemen to mount or dismount,

or defend themselves against approaching adversaries.

When the French Revolution came, the new regime wanted to change everything, especially old papal decrees. They decided to change the rules and make everyone drive on the right.

Consequently, all European countries that were conquered by Napoleon - and the

United States, which at that time was an ally of France - had to change to driving on the right.

The result is that today mainland Europe, the former European colonies and the U.S. drive on the right, while fifty two countries including Britain, the old British Empire, Japan, Indonesia and Thailand continue to drive on the left.



**JOHN COSTA**  
REALTOR ASSOCIATE

**COLDWELL BANKER**

RESIDENTIAL REAL ESTATE, INC.

(941) 966-0811 BUSINESS  
(888) 671-3848 TOLL FREE  
(941) 966-3581 FAX  
(941) 321-1585 CELLULAR  
(941) 918-1136 RESIDENCE  
john.costa@coldwellbanker.com

10006 Central Sarasota Parkway  
Sarasota, FL 34234



Owned And Operated By NHI Incorporated

**MLS**

Western Union - Money Orders - Keys - Notary

**MAIL/PAC "N" FAX**

**THE PLAZA AT PALMER RANCH**

8499 South Tamiami Trail  
Sarasota, Florida 34238

Tel: 941-923-5484  
Fax: 941-925-2946

**Rob Schloss**